

GROUND FLOOR PLAN

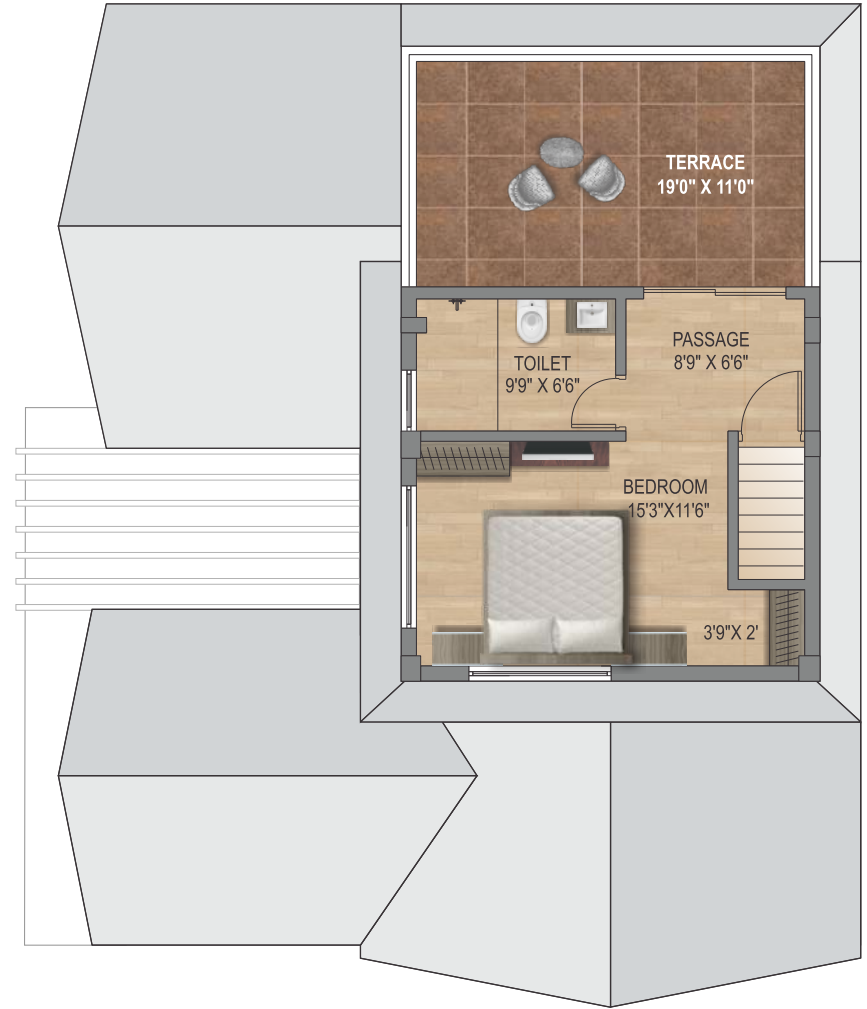

FIRST FLOOR PLAN



PREMIUM 3BHK VILLAS	
PARTICULARS	RERA CARPET AREA
Ground Floor	90.55 sqm
Verandah (Closed)	13.31 sqm
Court Yard	20.5 sqm
First Floor	34.74 sqm
Terrace	19.43 sqm
TOTAL AREAS	178.53 sqm

PREMIUM 3BHK VILLA
 Salable Area - 2218 Sq Ft